

Cable design

Center conductor	silver-plated copper covered steel
Dielectric	extruded PTFE
Outer conductor	seamless aluminium tubing, tin plated
Center conductor diameter	Ø 0,29 mm
Dielectric diameter	Ø 1,68 mm
Out-side diameter	Ø 2,20 mm (0.086 inch)
Weight	0,012 kg/m

Electrical data

Impedance	75 ohms
Frequency range	DC – 64 GHz.
Insertion loss	see graph
Shielding effectiveness	< -120 dB/m typical
Dielectric strength 60 Hz.	2,0 kVrms
Corona extinction	>1,2 kVrms

Mechanical and environmental data

Temperature range	-55 to +200°C
Bending radius	2,6 mm (proper tooling)

Semi Rigid hand formable

**EZ2 60B3
C/.086 TP**

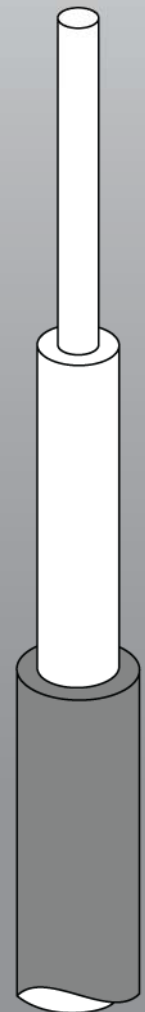

DC – 64 GHz

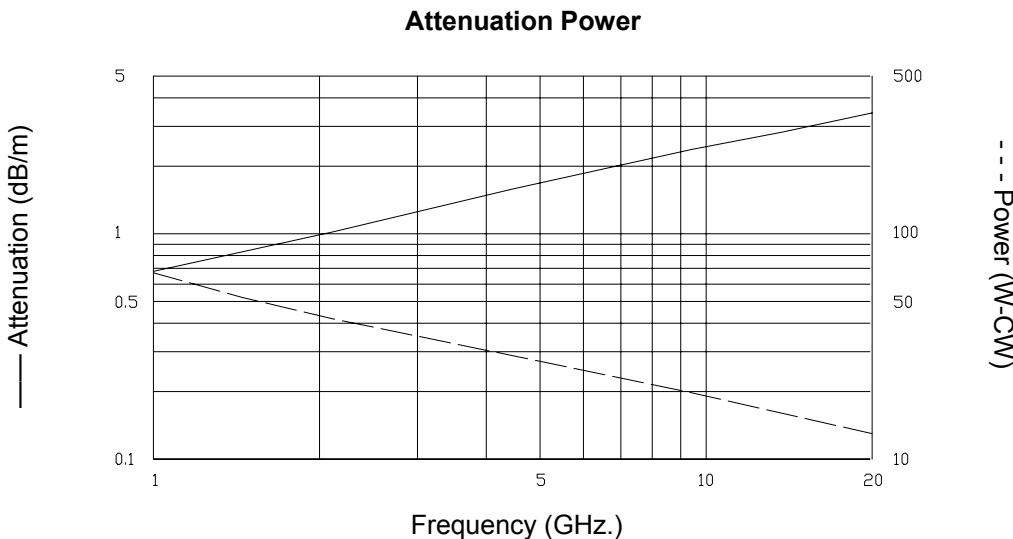

Please consult us for the required connectors.
We can supply cable harnesses made to your requirements.
Also available: High Dynamic Coaxial Cable.

**Gigalink Microwave
Connection Engineering B.V.**

Albert Plesmanweg 35 E
3088 GA Rotterdam
The Netherlands

Tel: +31 (0) 10 789 11 22
Fax: +31 (0) 10 789 11 44
E-mail: info@gigalink-mce.com