

**Cable design**

Center conductor	silver-plated copper
Dielectric	ePTFE
Outer conductor	seamless aluminium tubing
Center conductor diameter	Ø 0,57 mm
Dielectric diameter	Ø 1,68 mm
Out-side diameter	Ø 2,20 mm (0.086 inch)
Weight	0,010 kg/m

**Electrical data**

Impedance	50 ohms
Frequency range	DC – 64 GHz.
Insertion loss	see graph
Shielding effectiveness	< -120 dB/m typical
Dielectric strength 60 Hz.	2,5 kVrms
Corona extinction	>1,5 kVrms

**Mechanical and environmental data**

Temperature range	-55 to +250°C
Bending radius	6,4 mm (proper tooling)

Semi Rigid hand formable

**EZ2 6041  
C/.086**

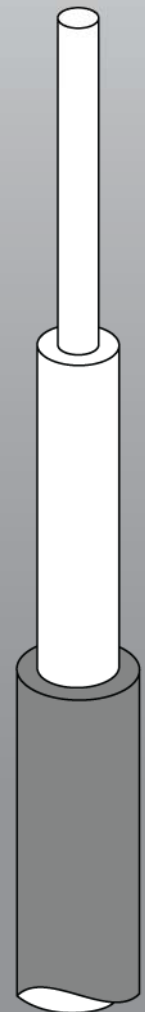

DC – 64 GHz

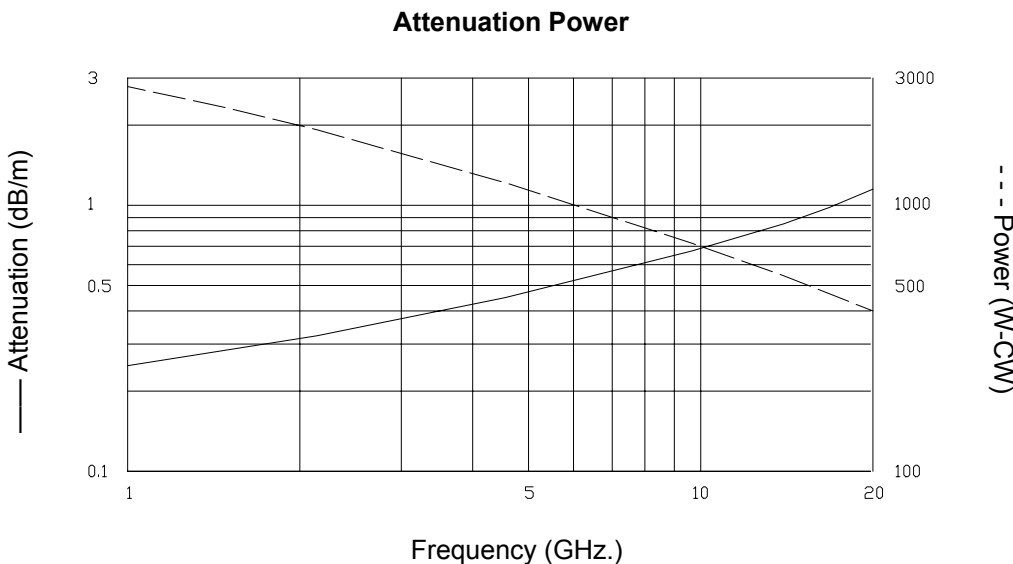

Please consult us for the required connectors.  
We can supply cable harnesses made to your requirements.  
Also available: High Dynamic Coaxial Cable.

**Gigalink Microwave  
Connection Engineering B.V.**

Albert Plesmanweg 35 E  
3088 GA Rotterdam  
The Netherlands

Tel: +31 (0) 10 789 11 22  
Fax: +31 (0) 10 789 11 44  
E-mail: info@gigalink-mce.com