

Cable design

Center conductor	silver-plated copper
Dielectric	ePTFE wrapped
Outer conductor	seamless copper tubing, tin plated
Center conductor diameter	Ø 1,16 mm
Dielectric diameter	Ø 3,05 mm
Out-side diameter	Ø 3,58 mm (0.141 inch)
Weight	0,041 kg/m

Electrical data

Impedance	50 ohms
Frequency range	DC – 40 GHz.
Insertion loss	see graph
Velocity of propagation	83 %
Shielding effectiveness	< -120 dB/m typical
Dielectric strength 60 Hz.	5,0 kVrms
Corona extinction	>1,0 kVrms

Mechanical and environmental data

Temperature range	-55 to +200°C
Bending radius	15,9 mm (proper tooling)

Semi Rigid hand formable

**EZ 9093
C/.141 TP**

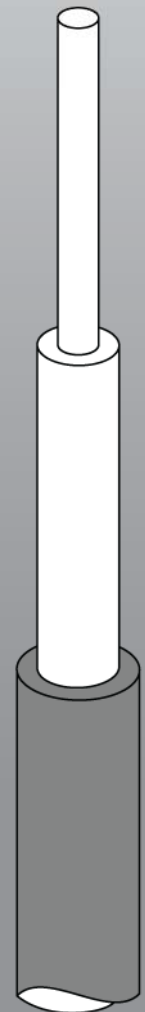

DC –40 Ghz

Attenuation Power

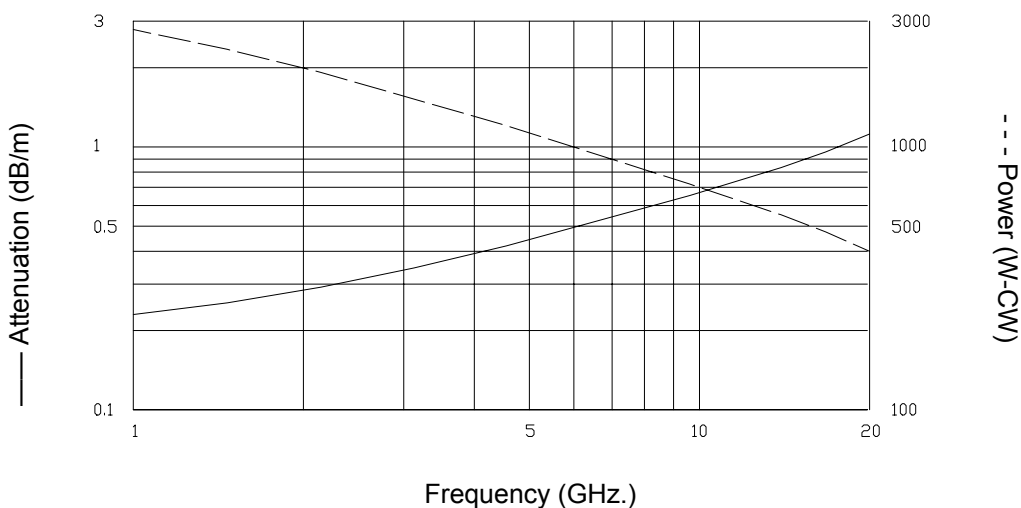

Please consult us for the required connectors.
We can supply cable harnesses made to your requirements.
Also available: High Dynamic Coaxial Cable.

**Gigalink Microwave
Connection Engineering B.V.**

Albert Plesmanweg 35 E
3088 GA Rotterdam
The Netherlands

Tel: +31 (0) 10 789 11 22
Fax: +31 (0) 10 789 11 44
E-mail: info@gigalink-mce.com