

Cable design

Center conductor	silver-plated copper covered steel
Dielectric	extruded PTFE
Outer conductor	seamless copper tubing, tin plated
Center conductor diameter	Ø 0,51 mm
Dielectric diameter	Ø 0,93 mm
Out-side diameter	Ø 1,19 mm (0.047 inch)
Weight	0,006 kg/m

Electrical data

Impedance	25 ohms
Frequency range	DC – 120 GHz.
Insertion loss	see graph
Shielding effectiveness	< -120 dB/m typical
Dielectric strength 60 Hz.	1,5 kVrms
Corona extinction	>0,85 kVrms

Mechanical and environmental data

Temperature range	-55 to +125°C
Bending radius	2,6 mm (proper tooling)

Semi Rigid hand formable

**EZ 10D3
C/.047 TP**

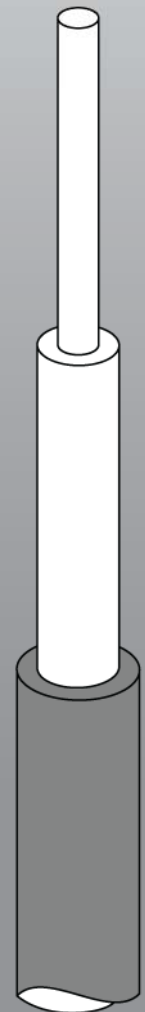

DC – 64 GHz

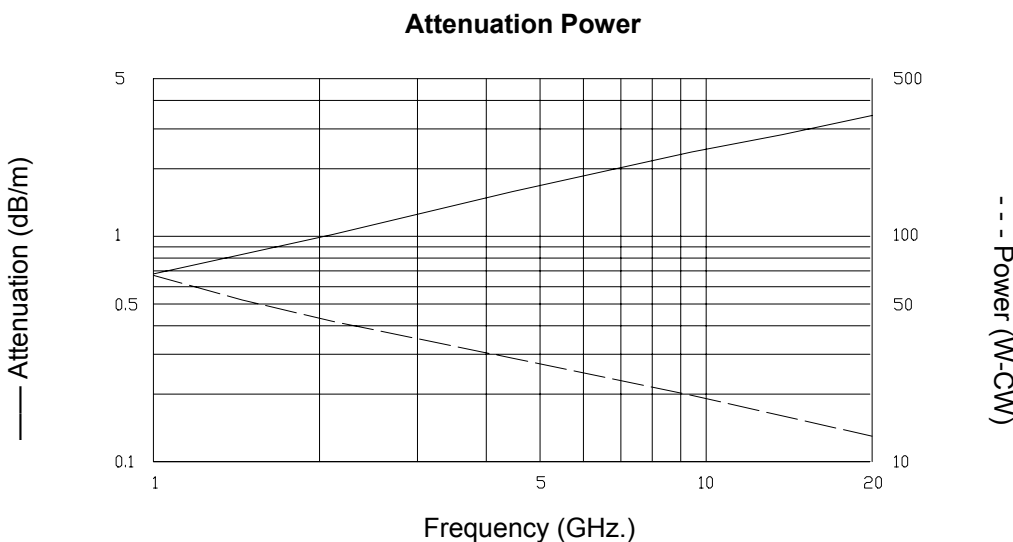

Please consult us for the required connectors.
We can supply cable harnesses made to your requirements.
Also available: High Dynamic Coaxial Cable.

**Gigalink Microwave
Connection Engineering B.V.**

Albert Plesmanweg 35 E
3088 GA Rotterdam
The Netherlands

Tel: + 31 (0) 10 789 11 22
Fax: +31 (0) 10 789 11 44
E-mail: info@gigalink-mce.com